

Cartridge Kit for High Torque Vane Motor



HM2 Series

Features

- The HM2 series cartridge kit is interchangeable with Vickers vane motor. It consists of a cam ring, rotor, 12 vanes.
- To change rotation, reverse the motor ports. No need to do anything with the cartridge.



Ordering Code

HM2 - 25

1

2

1 Vane Type Motor

2 Series (bi-directional rotation)

3 Ring Size - Nominal torque Rating

25 - 25 lb.in.Per 100 psi

35 - 35 lb.in.Pre 100 psi

Cartridge Kit HM2-210 Installation Dimensions mm (inch)

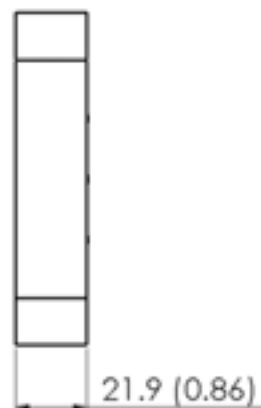
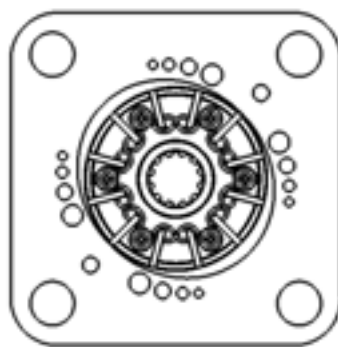

Model Series	Torque Nm/6,9 bar (lb in / 100psi)	Displacement cm ³ /r (in ³ /r)	Maximam Speed & Pressure	Approx Weight kg (lb)
HM2-210	2.0 (25)	24.7 (1.51)	2200 r/min @ 138 bar (2000 psi)	1.37 (3.0)
	4.0 (35)	35.4 (2.16)	1800 r/min @ 121 bar (1750 psi)	1.37 (3.0)